



TYPE **FREEHOLD**

PURPOSE **SUBDIVISION**

PLAN OF **LOT 8888**  
**ROAD WIDENINGS**  
**AND EASEMENT**

DISTRICT **ALBANY**

TOWNSITE **CITY OF ALBANY**

LOCAL AUTHORITY **MIDDLETON BEACH**

FORMER TENURE **INDEX ON**

SEE TABLE **BK26(2) 13:04**

FIELD BOOK **COMPILED**

S.S.A. (M)

SCALE 1:1000 (AT A3 SIZE)

ALL DISTANCES ARE IN METRES

**SURVEYOR'S CERTIFICATE - Reg 54**

I, **N. PAUL**, heretofore certified that this compiled plan is a correct and accurate representation of the survey(s) of the subject land, and (b) is in accordance with the relevant law in relation to which it is lodged.

*N. Paul*  
Licensed Surveyor  
2008.12.22.08.08.48.49.007

**SURVEYOR'S CERTIFICATE - Reg 54**

I, **N. PAUL**, heretofore certified that this compiled plan is a correct and accurate representation of the survey(s) of the subject land, and (b) is in accordance with the relevant law in relation to which it is lodged.

*N. Paul*  
Licensed Surveyor  
2008.12.22.08.08.48.49.007

LOGGED **DATE 17-Nov-08**

DATE PAID **\$251.00**

ASSESS No. **4535586**

IN ORDER FOR DEALINGS

SUBJECT TO *See 167 & 168 (3) Pt 1 of Act*

DATE **10/12/2009**

DELEGATED UNDER S. 16 OF P & D ACT 2005

**Landgate**  
Western Australian Land Information Authority

DEPOSITED PLAN

**52882**  
ORIGINAL

SHEET **1** OF **1** VERSION **2**

APPROVED *N. Paul*  
16.12.09  
FOR INSPECTOR OF PLANS & SURVEYS DATE AUTHORIZED LAND OFFICER

APPROVED *A. Adams*  
1-2-2010  
INSPECTOR OF PLANS & SURVEYS DATE AUTHORIZED LAND OFFICER

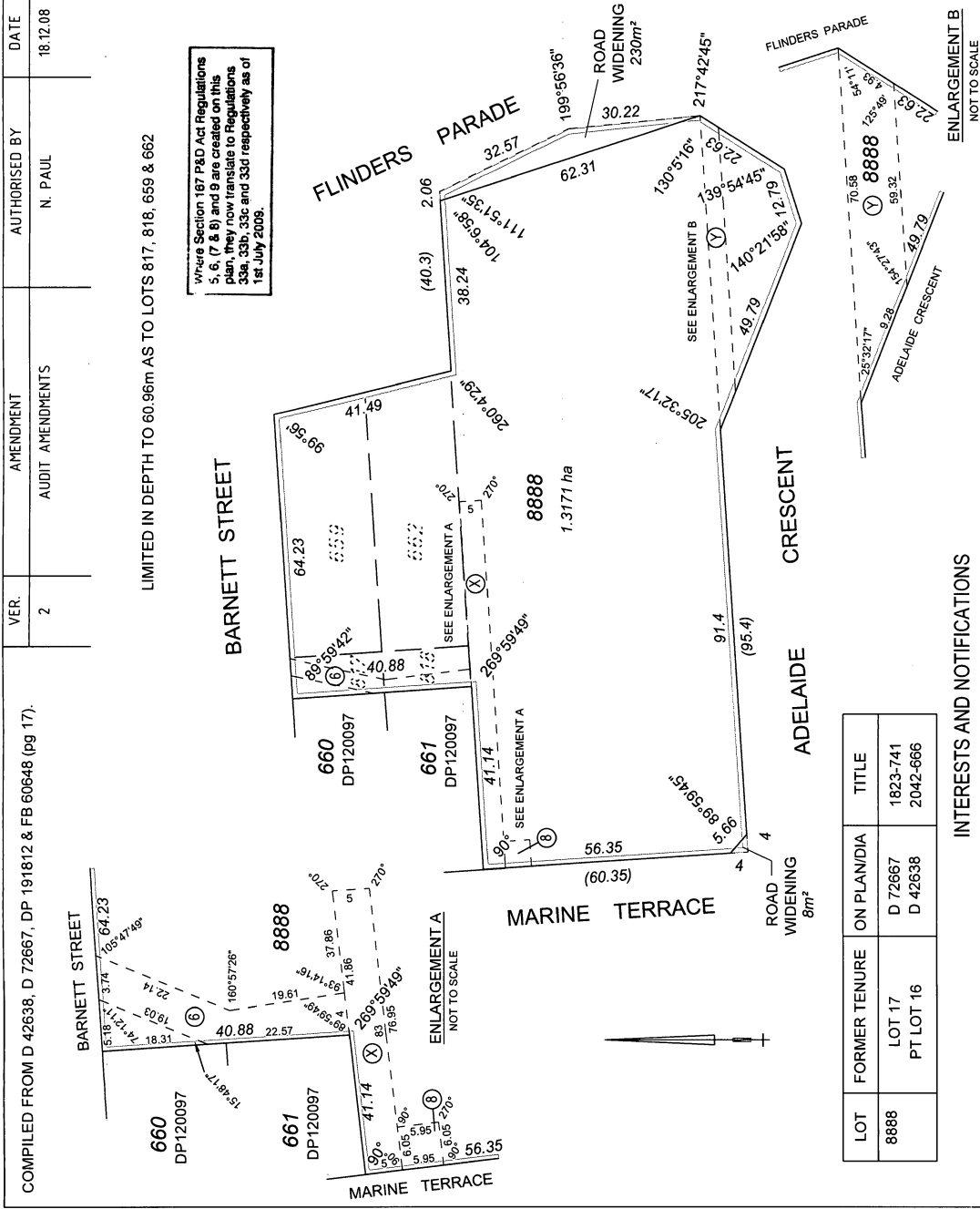

**INTERESTS AND NOTIFICATIONS**

| SUBJECT | PURPOSE                         | STATUTORY REFERENCE            | ORIGIN           | LAND BURDENED | BENEFIT TO                               | COMMENTS                                       |
|---------|---------------------------------|--------------------------------|------------------|---------------|--|--|
| (G)     | EASEMENT (SEWERAGE)             | SEC 27A of T.P. & D. ACT REG 6 | D 72667          | LOT 8888      | WESTERN AUSTRALIAN WATER AUTHORITY       |  |
| (X)     | EASEMENT                        |                                | TRANSFER E708461 | LOT 8888      | THE WATER AUTHORITY OF WESTERN AUSTRALIA |  |
| (Y)     | EASEMENT                        | SEC 134F OF LAND ACT           | TRANSFER F779313 | LOT 8888      | THE WATER AUTHORITY OF WESTERN AUSTRALIA |  |
| (B)     | EASEMENT (UNDERGROUND ELECTRIC) | SEC 167 P & D ACT REG 8        | THIS PLAN        | LOT 8888      | ELECTRICITY NETWORKS CORPORATION         | LIMITED IN HEIGHT TO 5.94m AHD (PADMOUNT SITE) |